

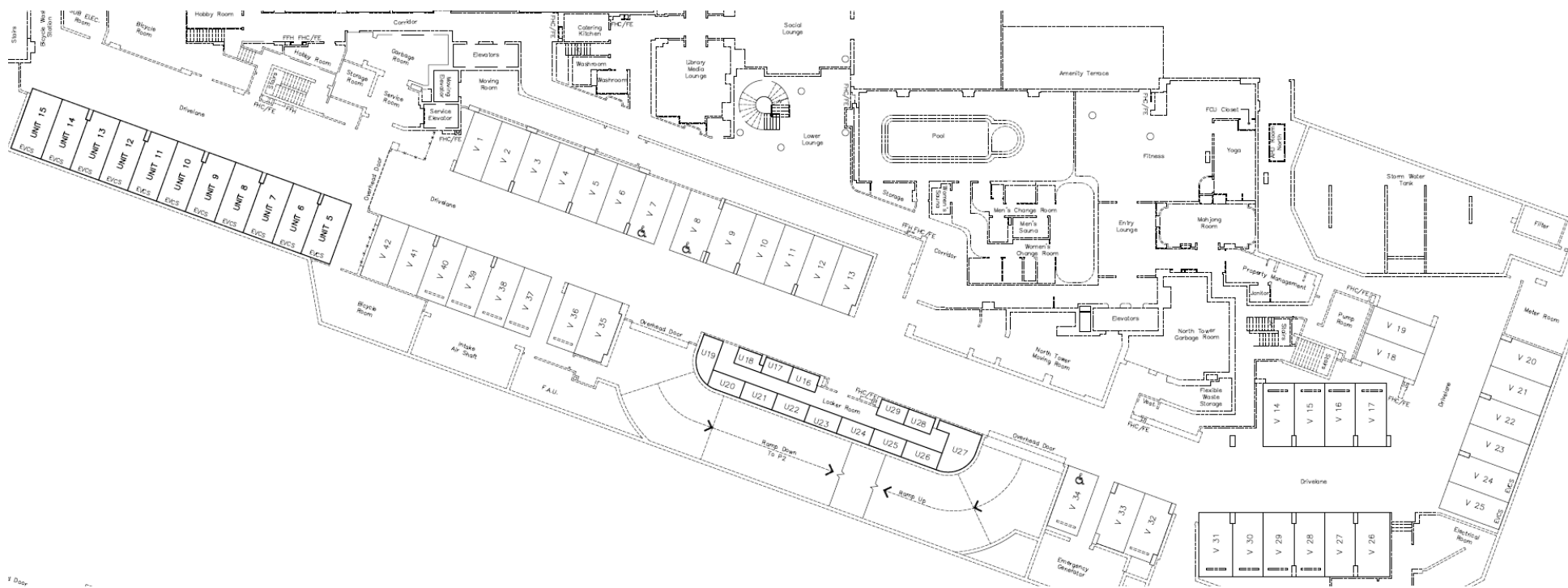

ROYAL BAYVIEW™



Parking Units - P1 Level Parking Units 5 - 15



This plan is provided for information purposes only. Parking & Locker unit locations are approximate and subject to change without notice. ©Tridel 2025. ©Tridel and design, "D" design, Tridel Built for Life and design, Built Green Built for Life and design are registered Trademarks of Tridel Corporation. Project names and logos are Trademarks of their respective owners. All rights reserved. Illustrations are artist's concept only. Specifications subject to change without notice. E.&O.E. April 2025



ROYAL BAYVIEW™

TRIDEL®
BUILT FOR LIFE

Parking Units - P2 Level

Parking Units 1 - 9, 15 -17, 19, 21, 23 - 25, 28 - 30, 32 - 51, 53 - 61, 63 - 105, 107 - 113, 119 -128, 130 & 131

Private Garage Parking Units 10 & 106

Parking / Storage Units 11 - 14, 18, 20, 22, 26, 27, 31, 52, 62, 114 - 118 & 129



This plan is provided for information purposes only. Parking & Locker unit locations are approximate and subject to change without notice. ©Tridel 2025. ®Tridel and design, "D" design, Tridel Built for Life and design, Built Green Built for Life and design are registered Trademarks of Tridel Corporation. Project names and logos are Trademarks of their respective owners. All rights reserved. Illustrations are artist's concept only. Specifications subject to change without notice. E.&O.E. September 2025



ROYAL BAYVIEW™

TRIDEL®
BUILT FOR LIFE

Parking Units - P3 Level

Parking Units 1 - 25, 27 - 39, 41 - 56, 58, 59, 61, 63, 65 - 67, 74 - 91 & 93 - 133

Parking / Storage Units 26, 40, 57, 60, 62, 64, 68 - 73 & 92



This plan is provided for information purposes only. Parking & Locker unit locations are approximate and subject to change without notice. ©Tridel 2025. ©Tridel and design, "D" design, Tridel Built for Life and design, Built Green Built for Life and design are registered Trademarks of Tridel Corporation. Project names and logos are Trademarks of their respective owners. All rights reserved. Illustrations are artist's concept only. Specifications subject to change without notice. E.&O.E. April 2025