

The DUPONT

RESIDENCES EAST OF OSSINGTON

TRIDEL
BUILT FOR LIFE

Locker Units - P2 Level

Units: 152 - 293



This plan is provided for information purposes only. Parking & Locker unit locations are approximate and subject to change without notice. ©Tridel 2025. ©Tridel and design, "D" design, Tridel Built for Life and design, Built Green Built for Life and design are registered Trademarks of Tridel Corporation. Project names and logos are Trademarks of their respective owners. All rights reserved. Illustrations are artist's concept only. Specifications subject to change without notice. E.&O.E. November 2025

The DUPONT

RESIDENCES EAST OF OSSINGTON

Locker Units - P2 Level

Units: 294 - 351

TRIDEL
BUILT FOR LIFE

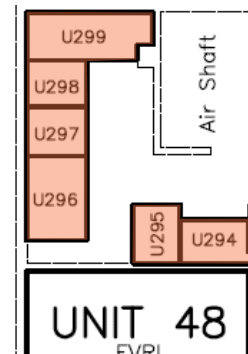
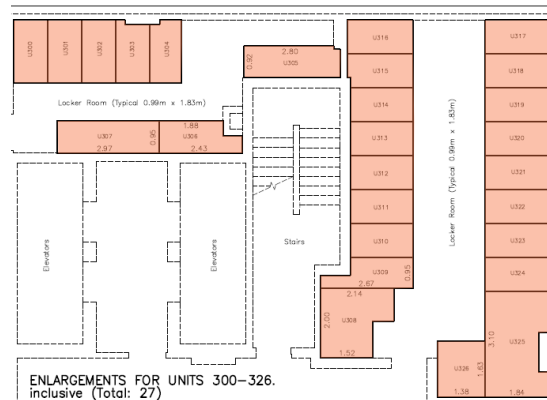
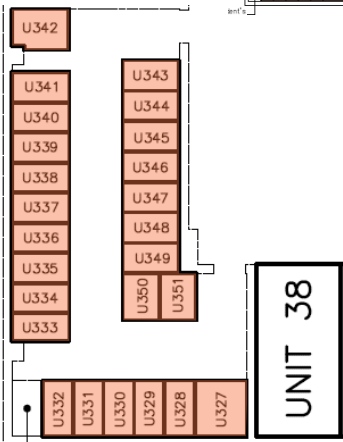

This plan is provided for information purposes only. Parking & Locker unit locations are approximate and subject to change without notice. ©Tridel 2025. @Tridel and design, "D" design, Tridel Built for Life and design, Built Green Built for Life and design are registered Trademarks of Tridel Corporation. Project names and logos are Trademarks of their respective owners. All rights reserved. Illustrations are artist's concept only. Specifications subject to change without notice. E.&O.E. August 2025