

# WESTERLY 2

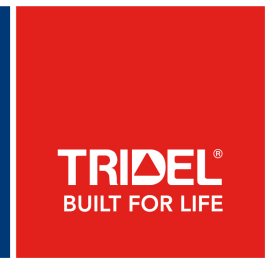

## Locker Units- P1 Level

Units: 65 - 110

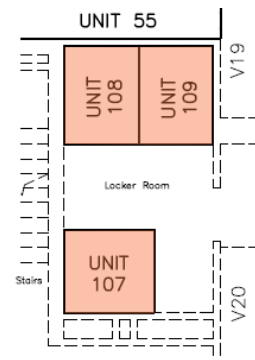
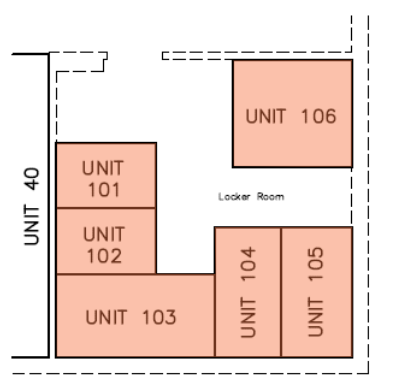
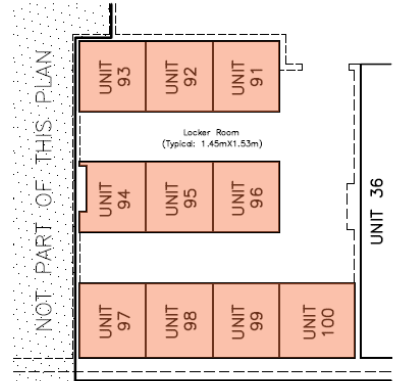
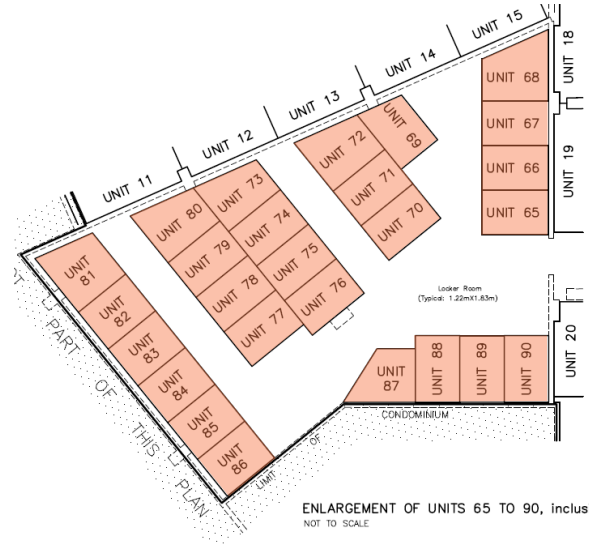

This plan is provided for information purposes only. Parking & Locker unit locations are approximate and subject to change without notice. ©Tridel 2025. ®Tridel and design, "D" design, Tridel Built for Life and design, Built Green Built for Life and design are registered Trademarks of Tridel Corporation. Project names and logos are Trademarks of their respective owners. All rights reserved. Illustrations are artist's concept only. Specifications subject to change without notice. E.&O.E. August 2025

# WESTERLY 2

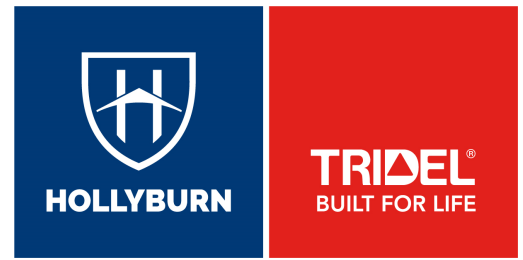

## Locker Units- P2 Level

Units: 106 - 149

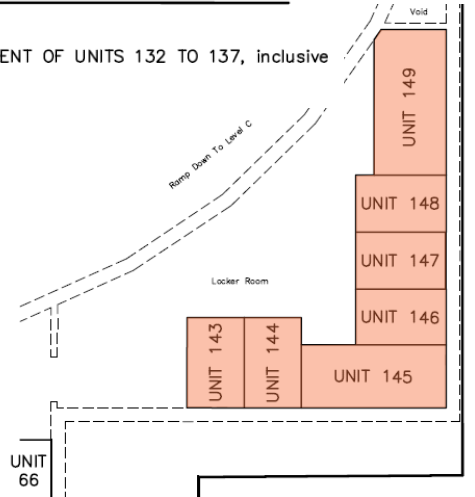
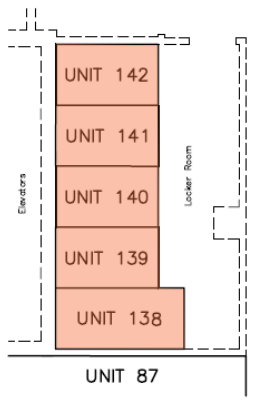
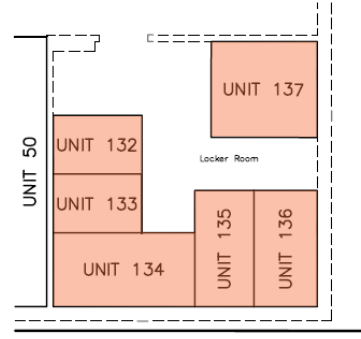
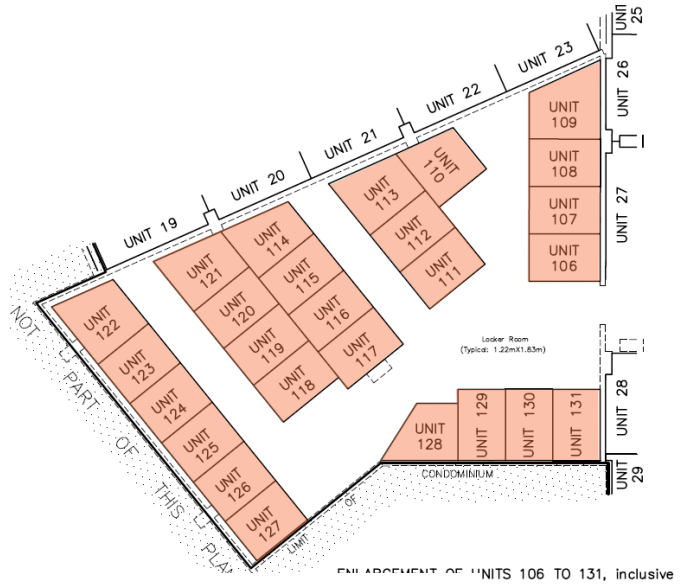

This plan is provided for information purposes only. Parking & Locker unit locations are approximate and subject to change without notice. ©Tridel 2025. ®Tridel and design, "D" design, Tridel Built for Life and design, Built Green Built for Life and design are registered Trademarks of Tridel Corporation. Project names and logos are Trademarks of their respective owners. All rights reserved. Illustrations are artist's concept only. Specifications subject to change without notice. E.&O.E. August 2025

# WESTERLY 2

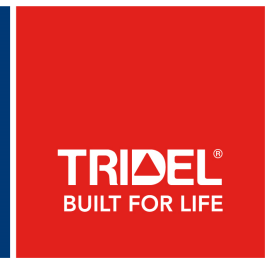

## Locker Units- P3 Level

Units: 108 - 153



This plan is provided for information purposes only. Parking & Locker unit locations are approximate and subject to change without notice. ©Tridel 2025. ®Tridel and design, "D" design, Tridel Built for Life and design, Built Green Built for Life and design are registered Trademarks of Tridel Corporation. Project names and logos are Trademarks of their respective owners. All rights reserved. Illustrations are artist's concept only. Specifications subject to change without notice. E.&O.E. August 2025