

WESTERLY

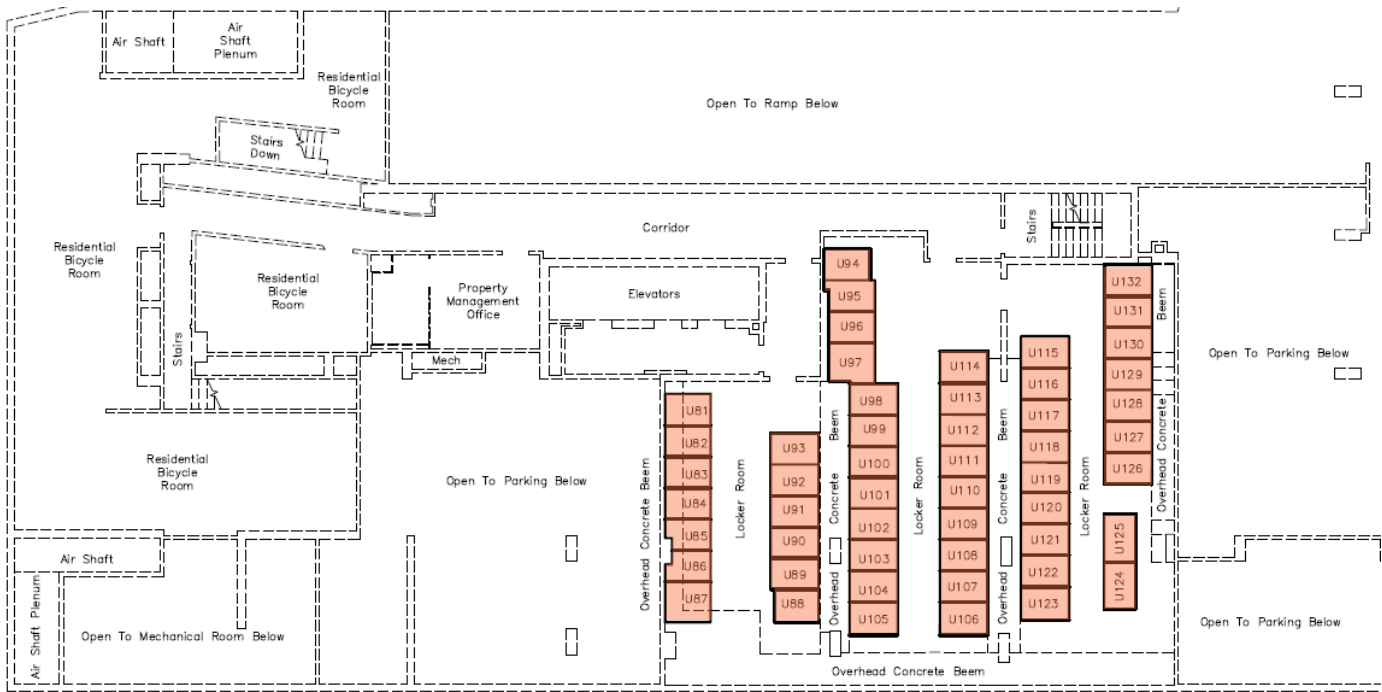

Locker Units - Mezzanine Level

Units: 81 - 132



ENLARGEMENT OF UNITS 81 TO 132, inclusive
NOT TO SCALE

This plan is provided for information purposes only. Parking & Locker unit locations are approximate and subject to change without notice. ©Tridel 2025. ®Tridel and design, "D" design, Tridel Built for Life and design, Built Green Built for Life and design are registered Trademarks of Tridel Corporation. Project names and logos are Trademarks of their respective owners. All rights reserved. Illustrations are artist's concept only. Specifications subject to change without notice. E.&O.E. November 2025

WESTERLY



Locker Units - P1 Level

Units: 50 - 80

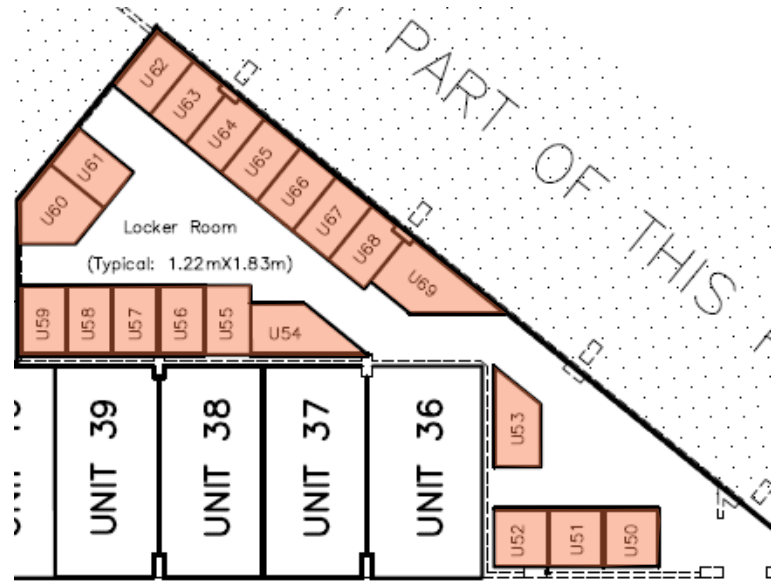

This plan is provided for information purposes only. Parking & Locker unit locations are approximate and subject to change without notice. ©Tridel 2025. ®Tridel and design, "D" design, Tridel Built for Life and design, Built Green Built for Life and design are registered Trademarks of Tridel Corporation. Project names and logos are Trademarks of their respective owners. All rights reserved. Illustrations are artist's concept only. Specifications subject to change without notice. E.&O.E. November 2025

WESTERLY



Locker Units - P2 Level

Units: 85 - 125

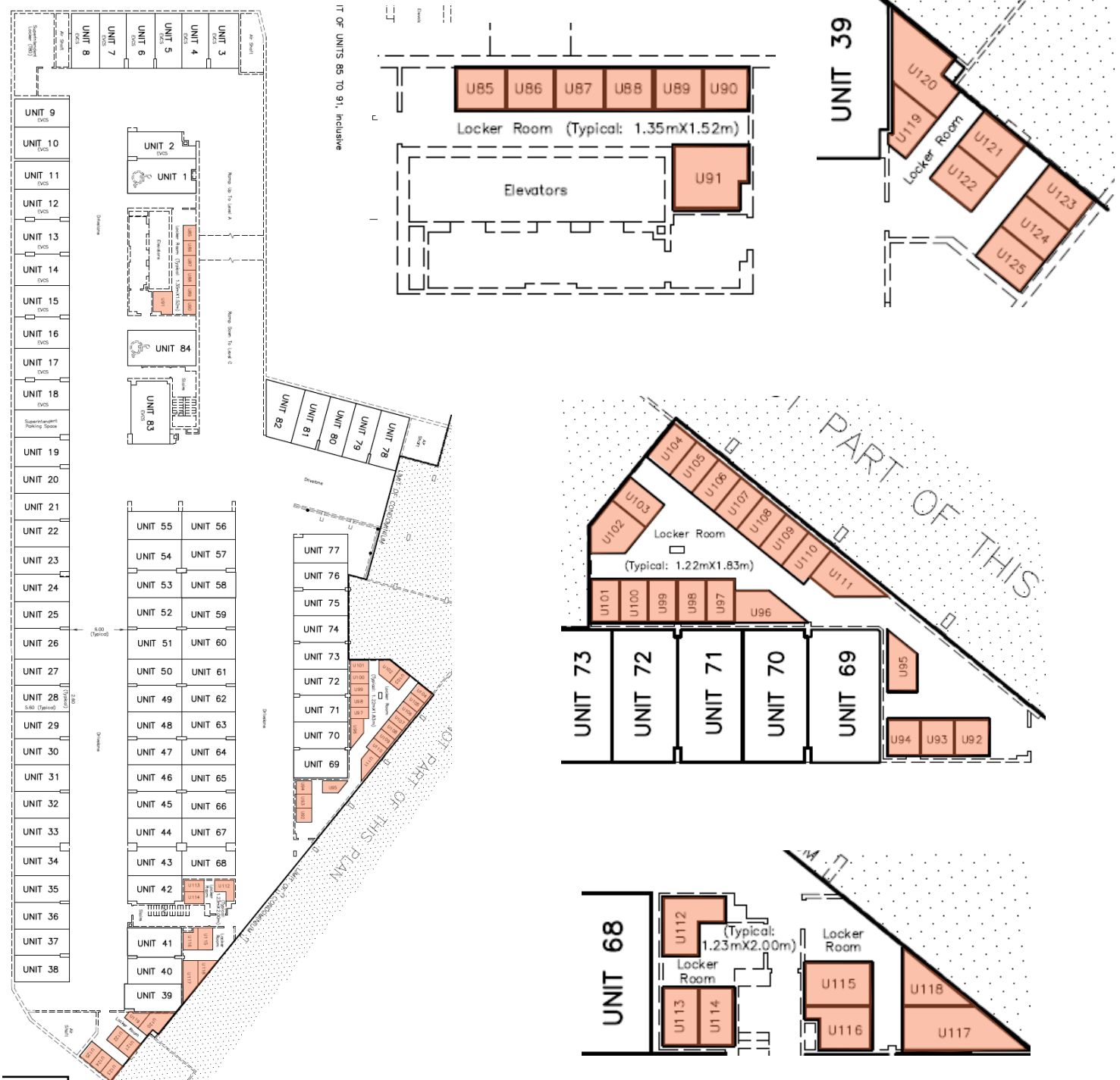

This plan is provided for information purposes only. Parking & Locker unit locations are approximate and subject to change without notice. ©Tridel 2025. ®Tridel and design, "D" design, Tridel Built for Life and design, Built Green Built for Life and design are registered Trademarks of Tridel Corporation. Project names and logos are Trademarks of their respective owners. All rights reserved. Illustrations are artist's concept only. Specifications subject to change without notice. E.&O.E. November 2025

WESTERLY



Locker Units - P3 Level

Units: 88 - 145



This plan is provided for information purposes only. Parking & Locker unit locations are approximate and subject to change without notice. ©Tridel 2025. ®Tridel and design, "D" design, Tridel Built for Life and design, Built Green Built for Life and design are registered Trademarks of Tridel Corporation. Project names and logos are Trademarks of their respective owners. All rights reserved. Illustrations are artist's concept only. Specifications subject to change without notice. E.&O.E. November 2025